

# TOPSEAL®

## Snap-in Tubeless Rubber Valves

OEM Quality  
Cold, Heat and Ozone Resistant  
No Tire Change without Valve Change

**S.C. "SEPROM" S.R.L.**  
Str. DINICU GOLESCU Nr. 4, Ap. 4  
FOCSANI  
C.I.F. RO 1453182; O.R.C. J 39/1001991  
Banca: BRD FOCSANI  
Cont: RO30 BRDE 400SV069 412 000



## Snap-in Tubeless Tire Valves

Generally used for Passenger Car, Trailers and Light Trucks  
For use to 65 psi / 4.5 bar cold inflation pressure maximum  
Recommended maximum rim thickness at rim hole is .156" / 4 mm.

No.	Part No.	Article No.	ETRTO	Rim Hole	A	C	E
1	TR413	01010100	V2.03.1	.453" / 11.3 mm	42.5	15	32
2	TR414	01010200	V2.03.2	.453" / 11.3 mm	48.5	15	38
3	TR414L	01010300	V2.03.8	.453" / 11.3 mm	56.5	15	46
4	TR418	01010400	V2.03.4	.453" / 11.3 mm	61.5	15	51
5	TR423	01010500	-	.453" / 11.3 mm	74	15	63.5
6	TR429	01010800	V2.03.9	8.8 mm	59	11	49.5

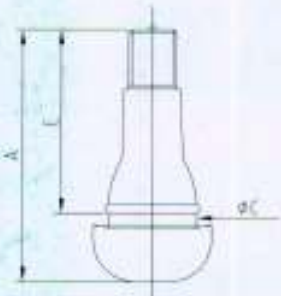

No.	Part No.	Article No.	ETRTO	Rim Hole	A	C	E
1	TR415	01010600	V2.03.3	.625" / 15.7 mm	42.5	19.2	32
2	TR425	01010700	-	.625" / 15.7 mm	61.5	19.2	51

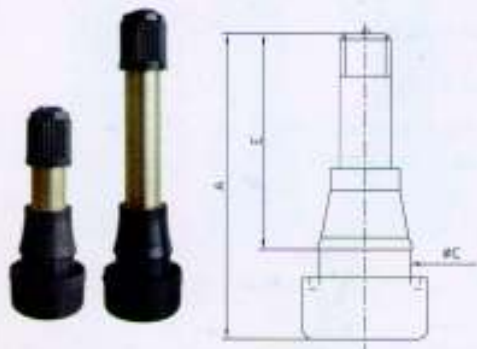

## Snap-in Tubeless Valves for High Pressure Application

Ideal for light trucks  
For use to 100 psi / 6.9 bar cold inflation pressure maximum  
Recommended maximum rim thickness at rim hole is .205" / 5.2 mm.

No.	Part No.	Article No.	Rim Hole	A	C	E
1	TR600HP	01013100	.453" / 11.3 mm	44	12	32
2	TR602HP	01013200	.453" / 11.3 mm	63	12	51
3	TR801HP	01013300	.625" / 15.7 mm	48	17	33
4	TR802HP	01013400	.625" / 15.7 mm	66	17	51

## Optional Cores & Caps (see page P.1 to P.3 for details) for Snap-ins

Part	Part No.	Article No.	Description
Core	TRC1-HT	02010300	Nickel plated short core, red sealing
	TRC1-HT	02010400	Brass finish short core, red sealing
Cap	TRVC8	02020100	Long plastic dust cap
	TRVC8-S	02020200	Short plastic dust cap
	TRVC8-SS	02020300	Short plastic sealing cap
	TRVC3-S	02020500	Short metal dome sealing cap



TR413 with short plastic cap



## Tubeless Metal Clamp-in Valves for Truck and Bus

For drop center rims

Recommended torque at installation: 35-55 inch-pounds / 4-6 Nm



No.	Part No.	Article No.	ETRTO	A
1	TR500	01030100	V3.21.3	51 <sup>V25</sup>
2	TR501	01030300	V3.21.2	38 <sup>V24</sup>
3	TR570	01030500	V3.21.4	80
4	TR571	01030700	V3.21.5	86
5	TR572	01030900	V3.21.6	95
6	TR573	01031100	V3.21.7	111
7	TR574	01031300	V3.21.8	127
8	TR575	01031400	V3.21.1	29 <sup>V29A</sup>

Rim Hole	Grommet	Washer	**Nut	Core	Cap
.625" / 15.7 mm	TRRG15 02030200	TRRW8 02050100	TRHN13 02040500	TRC1-HT 02010300	TRVC3 02020400

\*\*Nut for TR500-23 and TR575 is TRHN4.

No.	Part No.	Article No.	ETRTO	A <sub>1</sub>	B	α°
1	TR500-23	01030200	-	26	26	23
2	TR570C	01030600	V3.21.9	33	51	90
3	TR571C	01030800	V3.21.10	33	58	90
4	TR572C	01031000	V3.21.11	33	67	90
5	TR572-12	01031600	-	41	54	12
6	TR573C	01031200	V3.21.12	33	83	90
7	TR573-25	01031700	-	57	54	25

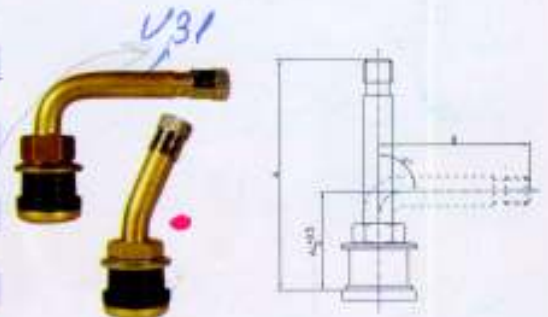

Various bend angles available upon request



### Oval Rim Hole Valve

Converts 16x6KS 750-16 GM Rims to Tubeless. This valve can be used only with a 16" tubeless tire.

Part No.	TR501-OV
Article No.	01030400
Rim Hole	.625" X .875" Oval
Grommet	BLRG10 02031800
Washer	BLRW9 BLRW10 02051600 02051700
Nut	TRHN13 02040500
Core	TRC1-HT 02010300
Cap	TRVC3 02020400



### BL570P

Article No.: 03050100

Rim hole plug to seal .625" / 15.7 mm rim hole when relocating valve



Part No.	BLV301
Article No.	01031500
Rim Hole	.453" / 11.3 mm
Finish	Nickel Plated
Grommet	BLRG12 BLRG13 02032000 02032100
Washer	BLRW7 02051500
Nut	TRHN4 02040400
Core	TRC1-HT 02010300
Cap	TRVC3-S 02020500



## Tubeless Nickel Plated O-Ring Seal Clamp-in Valves

For Alcoa aluminum truck wheels

Recommended torque at installation: 80-125 inch-pounds / 9-14 Nm

Commercial Vehicles



### Straight Type

No.	Part No.	Article No.	A
1	TR542	01032100	32
2	TR543	01032200	59
3	TR544	01032600	73
4	TR545	01032900	89
5	TR546	01033400	108



### Bend Type

No.	Part No.	Article No.	A	B	α
1	TR543C	01032300	24	35	45
2	TR543D	01032400	25	35	60
3	TR543E	01032500	25	35	75
4	TR544D	01032700	25	49	60
5	TR544E	01032800	25	49	75
6	TR545B	01033000	35	55.8	25
7	TR545-36	01033100	25	66	30
8	TR545D	01033200	25	66	60
9	TR545E	01033300	25	66	75
10	TR546B	01033500	25	85	25
11	TR546-36	01033600	25	85	30
12	TR546D	01033700	25	85	60
13	TR546E	01033800	25	85	75
14	TR547D	01033900	25	96	60

Rim Hole	O-Ring	**Nut	Core	Cap
.382"-.394" 9.7-10 mm	TRRG60 02033100	TRHN21 02040800	TRC1-HT 02010300	TRVC3 02020400

\*\*Hex nut for TR543C is TRHN22.

## Tubeless Clamp-in Valves for Drop Center Aluminum Disc Wheels

Recommended torque at installation:

100-125 inch-pounds / 11-14 Nm



No.	Part No.	Article No.	A
1	TR509	01037100	4.75" / 121
2	TR510	01037200	5.50" / 140
3	TR511	01037300	4.25" / 108

Rim Hole	Grommet	Nut	Core	Cap
.625" / 15.7 mm	TRRG46 02030600	TRHN17 02040700	TRC1-HT 02010300	TRVC3 02020400

## European Style O-Ring Seal Clamp-in Brass Valves

For wheels with wide base rims 15° tapered

Recommended torque at installation: 12-15 Nm / 105-130 inch-pounds

Commercial Vehicles



### Straight Type

No.	Part No.	Article No.	C
1	V3.20.1	01034100	36
2	V3.20.3	01034300	82
3	90MS9.7	01034500	85

### Single Bend Type

No.	Part No.	Article No.	A	B	X°
1	V3.20.2	01034200	30	60	17.5
2	V3.20.4	01034400	25	60	27
3	V3.20.5	01034600	25	40	27
4	110MS9.7-27	01035300	25	80	27
5	V3.20.6	01034700	25	85	27
6	115MS9.7-35	01035700	25	85	35
6	V3.20.7	01034800	25	50	27
7	V3.20.8	01034900	29	85	12
8	V3.20.10	01035000	50	25	27
9	V3.20.12	01035200	25	70	27

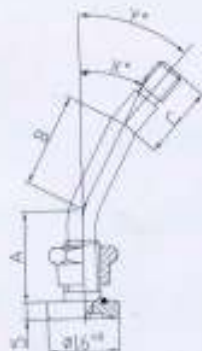

### Double Bend Type

No.	Part No.	Article No.	A	B	C	X°	Y°
1	V3.20.11	01035100	25	45	25	27	42
2	133MS	01035400	41	22	65	27	13

Various length and bend angles other than above specifications available upon request

### Optional Shapes of Bottom



Standard Bottom Shape  
Round, flat with slot

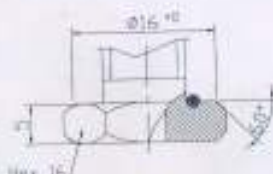

Hex Shape

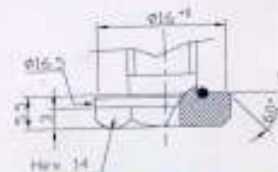

Round and Hex Combination

Rim Hole	O-Ring	Nut	Core	Cap
.382"-.394" 9.7-10 mm	V9.11.5 02033101	V9.07.2 02041100	TRC1-HT 02010300	TRVC3-S 02020500



# TOPSEAL®

## European Style O-Ring Seal Clamp-in Brass Valve

Commercial Vehicles

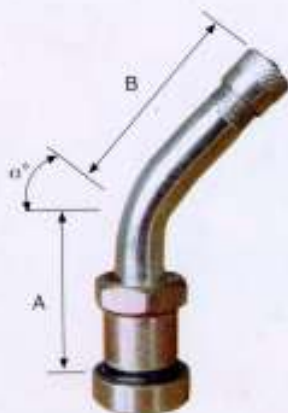

### 58MS9.7-45

For disc-wheels of Mercedes(Actros), Scania, Man, Volvo...  
With steel nuts color zined. Recommended torque at installation  
12-15 Nm / 105-130 inch-pounds

No.	Part No.	Article No.	A	B	α°
1	58MS9.7-45	01035500	25	28	45

*Dc1390  
(V48)*

Rim Hole	O-Ring	Nut	Core	Cap
.382"-.394" 9.7-10 mm	V9.11.5 02033101	BLHN10 02042200	TRC1-HT 02010300	TRVC3-S 02020500

### Bottom Shapes



Standard  
Flat bottom with slot



Optional  
Sphere shape

## European Style Clamp-in Valves for Truck and Bus

Recommended torque at installation: 25-31 Nm / 220-275 inch-pounds



One-piece type, for wheels with wide base rims 15° tapered and rim hole  
tire side, flat countersunk, at least dia. 27 mm and rim thickness up to 6 mm

No.	Part No.	Article No.	A	B	Y
1	V3.12.1	01036100	40	-	-
2	V3.12.2	01036200	95	-	-
3	V3.13.1	01036300	46.5	42.5	15
4	V3.13.2	01036400	30	79	12
5	V3.14.1	01036500	-	26	-
6	V3.14.2	01036600	-	45	-
7	V3.14.3	01036700	-	37	-



Rim Hole	O-Ring	Nut	Core	Cap
.625" / 15.7 mm	V9.11.4 02033400	V9.13.1 02041200	TRC1-HT 02010300	TRVC3-S 02020500

### BL3111

Scania valve, with lock screw.  
Article No.: 01036800

Rim Hole	Grommet	Screw	Core	Cap
.625" / 15.7 mm	BLRG14 02032200	BLLS9 02048200	TRC1-HT 02010300	TRVC3-S 02020500



BLLS9 Lock Screw  
Article No.: 02048200



# TOPSEAL®

## European Style O-Ring Seal Clamp-in Brass Valve

Commercial Vehicles



### 58MS9.7-45

For disc-wheels of Mercedes(Actros), Scania, Man, Volvo...  
With steel nuts color zined. Recommended torque at installation:  
12-15 Nm / 105-130 inch-pounds

No.	Part No.	Article No.	A	B	$\alpha^\circ$
1	58MS9.7-45	01035500	25	28	45

*De1390  
(V-1390)*

Rim Hole	O-Ring	Nut	Core	Cap
.382"-.394" 9.7-10 mm	V9.11.5 02033101	BLHN10 02042200	TRC1-HT 02010300	TRVC3-S 02020500

### Bottom Shapes



Standard  
Flat bottom with slot



Optional  
Sphere shape

## European Style Clamp-in Valves for Truck and Bus

Recommended torque at installation; 25-31 Nm / 220-275 inch-pounds



One-piece type; for wheels with wide base rims 15° tapered and rim hole on tire side, flat countersunk, at least dia. 27 mm and rim thickness up to 6 mm.

No.	Part No.	Article No.	A	B	Y°
1	V3.12.1	01036100	40	-	-
2	V3.12.2	01036200	95	-	-
3	V3.13.1	01036300	46.5	42.5	153
4	V3.13.2	01036400	30	79	126
5	V3.14.1	01036500	-	26	-
6	V3.14.2	01036600	-	45	-
7	V3.14.3	01036700	-	37	-



Rim Hole	O-Ring	Nut	Core	Cap
.625" / 15.7 mm	V9.11.4 02033400	V9.13.1 02041200	TRC1-HT 02010300	TRVC3-S 02020500

### BL3111

Scania valve, with lock screw.  
Article No.: 01036800

Rim Hole	Grommet	Screw	Core	Cap
.625" / 15.7 mm	BLRG14 02032200	BLLS9 02048200	TRC1-HT 02010300	TRVC3-S 02020500



BLLS9 Lock Screw  
Article No.: 02048200

# TOPSEAL®

## Air-Liquid Valves for Agricultural Tractors

Recommended torque at installation: 45-75 inch-pounds / 5-8.5 Nm



Metal clamp-in straight type

No.	Part No.	Article No.	ETRTO	A
1	TR618A	01040100	V5.01.1	28.5

V55



Metal clamp-in bend type

No.	Part No.	Article No.	ETRTO	A	B	α°
1	TR621A	01040200	V5.02.1	39	54.5	115
2	TR622A	01040300	V5.02.2	44.5	94.5	90
3	TR623A	01040400	V5.02.3	39	36.5	115

Rim Hole	Grommet	Washer	Nut	Core Housing	Core	Cap
.625" / 15.7 mm	TRRG7 02030100	TRRW11 02050200	TRHN1 02040200	TRCH3 02080100	TRC1-HT 02010300	TRVC3-S 02020500



**BLV601** = V58

Snap-in type

Article No.	01040500
Rim Hole	.625" / 15.7 mm
Core Housing	TRCH3 02080100
Core	TRC1-HT 02010300
Cap	TRVC3-S 02020500



**TRCH3**

Core housing

Article No.	02080100
O-Ring	TRRG67 02033300
Core	TRC1-HT 02010300
Cap	TRVC3-S 02020500

### Optional Valve Caps for Valves Illustrated from Page V.7 to V.11:



TRVC3-S  
02020500



TRVC3  
02020400



TRVC2  
02020600



TRVC8-SS  
02020300

For special needs, please inquire!



## Tubeless Valves for Motorcycles and Scooters

### TR412

Snap-in valve for go-carts, motor cultivators, industrial vehicles, rallye vehicles and motorcycles.



ETRTO V2.03.6  
Article No. 01050100  
Rim Hole .453" / 11.3 mm

Parts	Part No.	Article No.
Core	TRC1-HT	02010300
**Cap	TRVC8	02020100

### TR438

Snap-in valve



Article No. 01050600  
Rim Hole 8.8 mm

Parts	Part No.	Article No.
Core	TRC1-HT	02010300
**Cap	TRVC8	02020100

### TR412L

Snap-in valve for scooter



Article No. 01050400  
Rim Hole .453" / 11.3 mm

Parts	Part No.	Article No.
Core	TRC1-HT	02010300
**Cap	TRVC8	02020100

### BLV401

Snap-in valve for scooter



Article No. 01050500  
Rim Hole 8.8 mm

Parts	Part No.	Article No.
Core	TRC1-HT	02010300
**Cap	TRVC8	02020100

### TR430A

Metal clamp-in valve



Article No. 01050700  
Rim Hole .327" - .339" / 8.3-8.6 mm  
Finish Nickel Plated

Parts	Part No.	Article No.
Grommet	TRRG59	02030800
Washer	TRRW12	02050300
Nut	TRHN2	02040300
Core	TRC1-HT	02010300
Cap	TRVC3	02020400

### TR435

Metal clamp-in valve



Article No. 01050800  
Rim Hole .453" / 11.3 mm  
Finish Nickel Plated

Parts	Part No.	Article No.
Grommet	TRRG54	02030700
Washer	TRRW8	02050102
Nut	TRHN4	02040400
Core	TRC1-HT	02010300
Cap	TRVC3-S	02020500

Recommended torque at installation for metal clamp-in valve: 25-45 inch-pounds / 3-5 Nm

\*\*For optional caps, please see page P.3

### Optional Caps:

#### TR412C-L

Snap-in valve with long chrome sleeve and cap

Article No. 01050200  
Rim Hole .453" / 11.3 mm

Parts	Part No.	Article No.
Core	TRC1-HT	02010300
Cap	BLVC12	02021200
Sleeve	412CS-L	02062200



BLVC15  
02021500



BLVC13  
02021300

#### TR412C

Snap-in valve with normal chrome sleeve and cap

Article No. 01050300  
Rim Hole .453" / 11.3 mm

Parts	Part No.	Article No.
Core	TRC1-HT	02010300
Cap	BLVC12	02021200
Sleeve	412CS	02062100





## Large Bore Swivel Type Valves

Large bore swivel type tubeless valves for earthmover application  
For length over 6" / 152 mm, 2 lock nuts TRHN1 are fitted



### Single Bend Type

No.	Part No.	Article No.	Stem No.	ETRTO	Article No.	A	B	α°
1	TRJ650-03	01060200	TRJ650-02	V5.04.1	01060100	27	79	80
2	TRJ651-03	01060400	TRJ651-02	V5.04.2	01060300	32	119	90
3	TRJ652-03	01060600	TRJ652-02	-	01060500	27	140	86
4	TRJ653-03	01060800	TRJ653-02	-	01060700	27	64	80
5	TRJ654-03	01061000	TRJ654-02	-	01060900	27	79	60
6	TRJ655-03	01061200	TRJ655-02	-	01061100	27	79	74
7	TRJ656-03	01061400	TRJ656-02	-	01061300	67	94	90
8	TRJ657-03	01061600	TRJ657-02	-	01061500	27	102	80
9	TRJ658-03	01061800	TRJ658-02	-	01061700	27	140	80
10	TRJ659-03	01062000	TRJ659-02	-	01061900	48	89	90
11	TRJ660-03	01062200	TRJ660-02	-	01062100	48	222	90
12	TRJ669-03	01062400	TRJ669-02	-	01062300	27	64	90

### Double Bend Type



No.	Part No.	Article No.	Stem No.	Article No.	A	B	x°	y°
1	TRJ661-03	01062900	TRJ661-02	01062800	48	114	82	8
2	TRJ664-03	01063100	TRJ664-02	01063000	102	222	90	13
3	TRJ667-03	01063300	TRJ667-02	01063200	76	191	90	11

### Triple Bend and Quadruple Bend Type

No.	Part No.	Article No.	Stem No.	Article No.	A	C	D	B	z°	y°	x°	w°
1	TRJ662-03	01063500	TRJ662-02	01063400	-	114	149	356	90	-	20	20
2	TRJ663-03	01063700	TRJ663-02	01063600	-	51	152	635	90	-	8	8
3	TRJ665-03	01063900	TRJ665-02	01063800	-	51	151	813	90	-	13	13
4	TRJ666-03	01064100	TRJ666-02	01064000	83	111	158	511	84	6	31	31

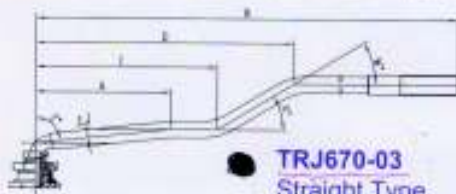

TRJ670-03  
Straight Type



Article No.	01062600
Rim Hole	.812" / 20.5 mm
Stem	TRJ670-02 ETRTO V5.03.1 01062500
Spud	TRSP2 01066000
O-Ring	TRRG66 02033200
Core	TRC2 02012100
Cap	TRVC7 02023200

Rim Hole	Spud	O-Ring	Core	Cap
.812" / 20.5 mm	TRSP2 01066000	TRRG66 02033200	TRC2 02012100	TRVC7 02023200



TRJ6XX-03  
||  
TRJ6XX-02  
+  
TRSP2

### TRSP2

ETRTO V5.10.1

Large bore tubeless spud.  
Recommended torque at  
installation: 175-200 inch-pounds  
/ 20-23 Nm

Article No.	01066000
Rim Hole	.812" / 20.5 mm
Grommet	TRRG22 02030400
Nut	TRHN15 02040600



## Large Bore Swivel Type Valve Stems

May be used with TRSP2 tubeless spud or TRSP4000 tube spud  
For length over 6" / 152 mm, 2 lock nuts TRHN1 are fitted.



No.	Part No.	Article No.	Horiz. Length		O-ring	Nuts	Core	Cap
1	TRJ4000-2.50	01064200	2 1/2"	64mm				
2	TRJ4000-4	01064300	4"	102mm				
3	TRJ4000-4.50	01064400	4 1/2"	114mm				
4	TRJ4000-6	01064500	6"	152mm				
5	TRJ4000-7.50	01064600	7 1/2"	191mm				
6	TRJ4000-8	01064700	8"	203mm				
7	TRJ4000-8.50	01064800	8 1/2"	216mm	TRRG66	TRHN1	TRC2	TRVC7
8	TRJ4000-9	01064900	9"	229mm	02033200	02040200	02012100	02023200
9	TRJ4000-10	01065000	10"	254mm				
10	TRJ4000-20	01065100	20"	508mm				
11	TRJ4000-24	01065200	24"	610mm				
12	TRJ4000-25.50	01065300	25 1/2"	648mm				
13	TRJ4000-28	01065400	28"	711mm				
14	TRJ4000-29.50	01065500	29 1/2"	749mm				

Various length other than above specifications available upon request

## Large Bore Turret Type Valves

Recommended torque at installation: 175-200 inch-pounds / 20-23 Nm

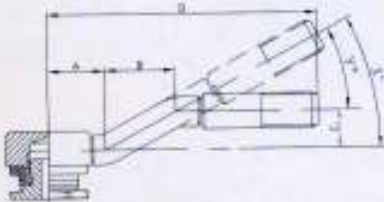

No.	Part No.	ETRTO	Article No.	A	B	C	D	X°	Y°
1	TRJ691	V5.09.1	01066100	16	-	-	84	18	-
2	TRJ694	-	01066200	20	-	-	89	28	-
3	TRJ690	V5.05.1	01066300	32	59	14	119	28	28
4	TRJ692	-	01066400	32	59	14	119	18	28
5	TRJ693	-	01066500	22	43	21	127	60	60
6	TRJ695	-	01066600	21	38	25	105	50	50
7	TRJ696	-	01066700	27	52	23	108	42	42

Rim Hole	Grommet	Nut	Core	Cap
.812" / 20.5 mm	TRRG16 02030300	TRLS7 02048100	TRC2 02012100	TRVC7 02023200

### Optional Caps for Large Bore Valves



#### TRJ671

Art. No.: 01062700  
Screw-in type  
valve with 1/4"  
male pipe thread



TRLS7 Lock Screw  
ETRTO V5.13.1  
Article No.: 02048100



TRVC6  
Art. No.: 02023100



TRVC7  
Art. No.: 02023200



# TOPSEAL®

## Michelin Type Screw-on Universal Valves for Truck and Bus

No.	Part No.	Article No.	A	B	C	D	$\alpha^\circ$	$\beta^\circ$	$\gamma^\circ$
-----	----------	-------------	---	---	---	---	----------------	---------------	----------------

### Single Bend Type

1	V3.02.2	01110100	22.5	43	-	-	120	-	-
2	V3.02.3	01110200	33	44.5	-	-	95	-	-
3	V3.02.5	01110300	20.5	47.5	-	-	90	-	-
4	V3.02.7	01110400	22.5	71.5	-	-	100	-	-
5	V3.02.8	01110500	20.5	89.5	-	-	94	-	-
6	V3.02.9	01110600	20.5	99.5	-	-	94	-	-
7	V3.02.10	01110700	20.5	115	-	-	94	-	-
8	V3.02.11	01110800	20	126	-	-	98	-	-
9	V3.02.12	01110900	20.5	132	-	-	94	-	-
10	V3.02.13	01111000	20.5	133.5	-	-	90	-	-
11	V3.02.14	01111200	20.5	138.5	-	-	94	-	-
12	V3.02.15	01111300	20.5	145.5	-	-	94	-	-
13	V3.02.16	01111400	20.5	149.5	-	-	90	-	-
14	V3.02.17	01111500	20.5	156.5	-	-	90	-	-
15	V3.02.18	01111600	22.5	74.5	-	-	90	-	-
16	V3.02.19	01111700	20.5	60	-	-	94	-	-
17	V3.02.23	01111800	29.5	66.5	-	-	90	-	-
18	V3.02.24	01111900	20.5	117	-	-	90	-	-
19	V3.02.27	01112000	20	75	-	-	94	-	-

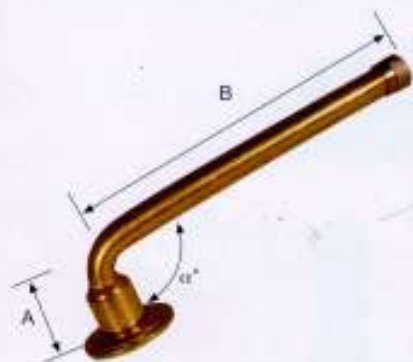

### Double Bend Type

20	V3.04.1	01112100	20.5	32	37	-	90	138	-
21	V3.04.2	01112200	20.5	38	41.5	-	90	153	-
22	V3.04.3	01112300	20	59	38.5	-	94	163	-
23	V3.04.4	01112400	20	74	40	-	94	144	-
24	V3.04.5	01112500	20	76	47.5	-	90	153	-
25	V3.04.6	01112600	20	86	47.5	-	90	153	-
26	V3.04.10	01112700	20.5	47	53	-	90	154	-
27	V3.04.11	01112800	20.5	47	63.5	-	90	154	-
28	V3.04.17	01112900	20	65	45	-	90	160	-
29	V3.04.24	01113000	20	58	47	-	94	164	-
30	V3.04.26	01113100	20	99	47	-	99	189	-

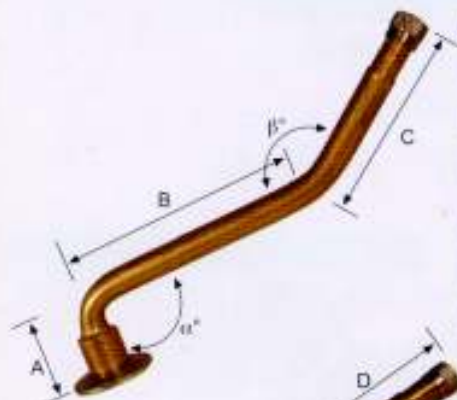

### Triple Bend Type

31	V3.06.1	01113200	20.5	30.5	19.5	35.5	90	139	139
32	V3.06.2	01113300	20.5	44.5	12	37.5	90	125	125
33	V3.06.3	01113400	20.5	46	20.5	47.5	90	140	140
34	V3.06.5	01113500	20.5	62.5	19.5	49	90	139	139
35	V3.06.6	01113600	20	79.5	19.5	37.5	90	139	139
36	V3.06.7	01113700	20.5	45.5	18.5	42.5	90	137	137
37	V3.06.8	01113800	24.5	61.5	14.5	50.5	94	153	153
38	V3.06.9	01113900	20.5	67.5	19.5	54.5	90	139	139
39	V3.06.12	01114000	23.5	71.5	19.5	25.5	90	150	150
40	V3.06.14	01114100	20	50	13	40	94	153	153
41	V3.06.15	01114200	20	60	13	40	94	153	153
42	V3.06.16	01114300	20	62	13	50	94	153	153
43	V3.06.17	01114400	20	75	13	50	94	153	153

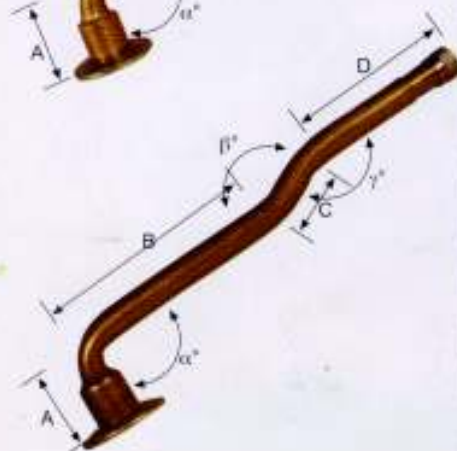

### Screw-on Repair Valves

No.	Part No.	Article No.	Part No.	**Art. No.	A
1	TR1075A	01115100	TR1075A-BW	01115200	3" / 76 mm
2	TR1076A	01115300	TR1076A-BW	01115400	3.4" / 85 mm
3	TR1077A	01115500	TR1077A-BW	01115600	4.1" / 104 mm
4	TR1078A	01115700	TR1078A-BW	01115800	5" / 127 mm
5	TR1175A	01115900	TR1175A-BW	01116000	4.5" / 114 mm
6	TR1177A	01116100	TR1177A-BW	01116200	3.7" / 94 mm
7	TR1178A	01116300	TR1178A-BW	01116400	5.4" / 135 mm
8	TR1179A	01116500	TR1179A-BW	01116600	5.6" / 142 mm
9	TR1227A	01116700	TR1227A-BW	01116800	2" / 50 mm
10	TR1274A	01116900	TR1274A-BW	01117000	2.4" / 60 mm



\*\*with bridge washer

Tube Valves



# TOPSEAL®

## Tube Valves for Passenger Cars and Light Trucks



No.	Part No.	ETRTO	Article No.	Rim Hole	A	B	C
1	TR13	V2.01.1	01130100	.453" / 11.3 mm	57	38	11.6
2	TR15	V2.01.2	01130200	.625" / 15.7 mm	57	38	16.5

### TRB6

Article No.: 02060100  
Plastic valve bushing  
Covers TR13 to fit .625" rim hole



TR13 plus TRB6

## Tube Valves for Bicycles

Fit 8.3 mm rim hole



No.	Part No.	ETRTO	Article No.	A
1	TR1-25	V1.07.1	01131200	25
2	TR1-28	-	01131300	28
3	TR1-32	-	01131400	32



No.	Part No.	Article No.	A
1	V1.04.1	01131100	25

Tube Valves

## Rubber Based Spuds



For Michelin type screw-on universal valves

No.	Part No.	Article No.	A	B
1	V3.08.2	01114800	70	7
2	V3.08.3	01114900	80	8
3	V3.08.4	01115000	57	5

### TRSP1000

For screw-on repair valves

No.	Part No.	Article No.	A	B
1	TRSP1000	01117100	82	7



# TOPSEAL®

## Rubber Based Tube Valves for Truck and Bus



No.	Part No.	Article No.	A	B	Core	Cap
1	TR75A	01133100	95	88		
2	TR77A	01133200	95	118		
3	TR78A	01133300	95	143	TRC1-HT	TRVC3
4	TR175A	01133400	95	128	02010300	02020400
5	TR177A	01133500	95	108		
6	TR179A	01133600	95	158		

## Air-Liquid Tube Valves for Tractors and Graders



### TRLN10 Lock Nut

ETRTO V9.14.1

No.	Article No.	Material
1	02040100	Brass
2	02040101	Nylon



### BLV201

Metal clamp-in air-liquid tube valve

Article No.: 01134300

Parts	Part No.
Washer	BLRW21 02051800
Nut	TRHN1 BLHN11 02040200 02042300
Core Housing	TRCH3 02080100

No.	Part No.	ETRTO	Article No.	A	Spud	Core Housing	Lock Nut
1	TR218A	V4.01.1	01134100	27	TRSP218A 01134400	TRCH3	TRLN10
2	TR220A	V4.01.2	01134200	35.5	TRSP220A 01134500	02080100	02040100

## Tube Valves for Motorcycles



### TR87

ETRTO V1.08.1  
Article No.: 01132200

Parts	Part No.
Core	TRC1 02010100
Cap	TRVC8 02020100



### TR4

ETRTO V1.09.1  
Article No.: 01132100

Parts	Part No.
Nuts	BN1 02041301
Core	TRC1 02010100
Cap	TRVC8 02020100